

SUTTON
REAL ESTATE COMPANY

FOR SALE OR LEASE | PROFESSIONAL OFFICE

8016 East Genesee Street, Fayetteville, NY 13066



PROPERTY FEATURES

- 5,200 +/- SF on 1.63 acres
- Beautiful Fayetteville Setting Overlooking Pond- Minutes from Green Lakes State Park
- 16 private offices
- 9 rooms with wiring and plumbing in place for Nitrous oxide/oxygen with automatic empty tank change over system; two sinks in each of the 9 private rooms
- Four bathrooms—2 visitors, 1 staff and 1 private
- Large bullpen area
- Conference room
- Business/reception area, 10 work stations, 2 private business offices
- Staff breakroom with full kitchen
- 30+/- parking spaces
- 4 HVAC zones with anti-viral & anti-bacterial UV air sanitizers
- Additional 3,000 SF in lower level for storage

CONTACT EXCLUSIVE AGENT:

Barton K. Feinberg

Director of Brokerage, Associate Broker

(M) 315.447.8668

bfeinberg@suttoncos.com

SUTTON REAL ESTATE COMPANY

525 Plum Street, Suite 100

Syracuse, New York 13204

315.424.1111

www.suttoncos.com

All information contained herein is from sources deemed reliable and is submitted subjected to errors, omissions, changes in price or other conditions, prior sale, leasing without notice. Principals should not rely solely upon the information contained herein.

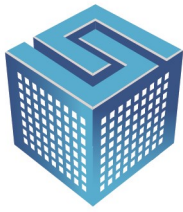

SUTTON
REAL ESTATE COMPANY

FOR SALE OR LEASE | PROFESSIONAL OFFICE

8016 East Genesee Street, Fayetteville, NY 13066

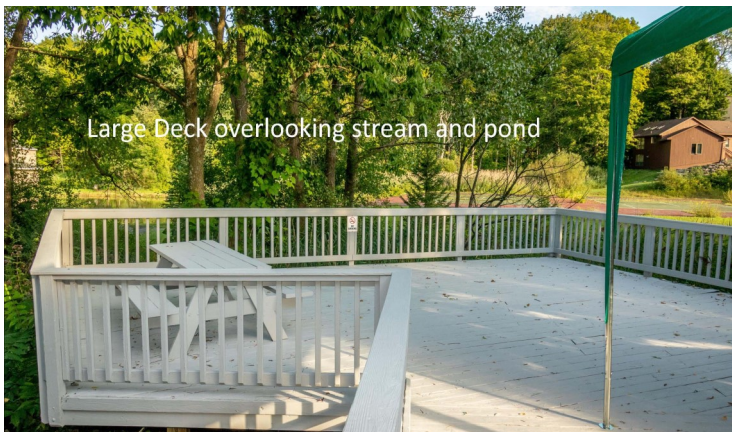

CONTACT EXCLUSIVE AGENT:

Barton K. Feinberg

Director of Brokerage, Associate Broker

(M) 315.447.8668

bfeinberg@suttoncos.com

SUTTON REAL ESTATE COMPANY

525 Plum Street, Suite 100

Syracuse, New York 13204

315.424.1111

www.suttoncos.com

All information contained herein is from sources deemed reliable and is submitted subjected to errors, omissions, changes in price or other conditions, prior sale, leasing without notice. Principals should not rely solely upon the information contained herein.

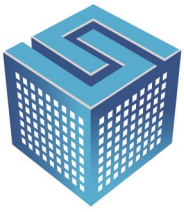

SUTTON
REAL ESTATE COMPANY

FOR SALE OR LEASE | PROFESSIONAL OFFICE

8016 East Genesee Street, Fayetteville, NY 13066



Reception Area
Modified Due to
Covid-19



Consultation
Room

CONTACT EXCLUSIVE AGENT:

Barton K. Feinberg
Director of Brokerage, Associate Broker

(M) 315.447.8668
bfeinberg@suttoncos.com

SUTTON REAL ESTATE COMPANY

525 Plum Street, Suite 100
Syracuse, New York 13204
315.424.1111
www.suttoncos.com

All information contained herein is from sources deemed reliable and is submitted subjected to errors, omissions, changes in price or other conditions, prior sale, leasing without notice. Principals should not rely solely upon the information contained herein.

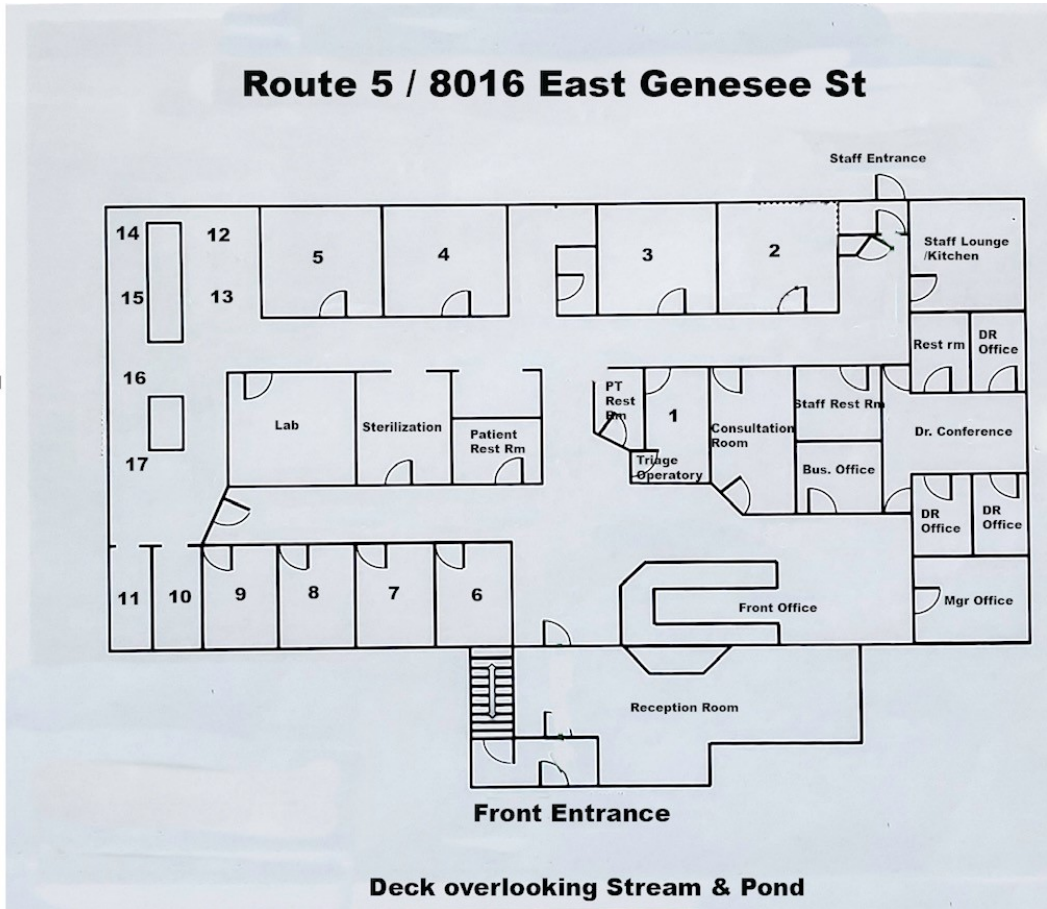
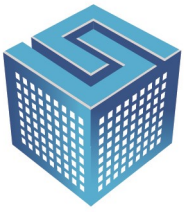

DEMOGRAPHICS

	1 Mile	3 Mile	5 Mile
Population	1,538	19,106	24,041
Households	691	8,301	9,410
Average Household Income	\$116,537	\$91,223	\$84,783

TRAFFIC COUNTS

- 10,940 AADT NYS DOT 2008

CONTACT EXCLUSIVE AGENT:

Barton K. Feinberg
Director of Brokerage, Associate Broker
(M) 315.447.8668
bfeinberg@suttoncos.com

SUTTON REAL ESTATE COMPANY

525 Plum Street, Suite 100
Syracuse, New York 13204
315.424.1111
www.suttoncos.com

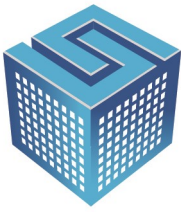

SUTTON
REAL ESTATE COMPANY

FOR SALE OR LEASE | PROFESSIONAL OFFICE

8016 East Genesee Street, Fayetteville, NY 13066



Four Seasons Golf & Ski/Tubing Hill
(neighbor to the west)



Spring Fed Pond Adjacent to Office

CONTACT EXCLUSIVE AGENT:

Barton K. Feinberg

Director of Brokerage, Associate Broker

(M) 315.447.8668

bfeinberg@suttoncos.com

SUTTON REAL ESTATE COMPANY

525 Plum Street, Suite 100

Syracuse, New York 13204

315.424.1111

www.suttoncos.com

All information contained herein is from sources deemed reliable and is submitted subjected to errors, omissions, changes in price or other conditions, prior sale, leasing without notice. Principals should not rely solely upon the information contained herein.